

Surface-mounted luminaire - Multilayer lighting technology - direct distribution

Sheet steel housing suitable, rectangular cross section; suitable for use in clean rooms and clean room areas per DIN 14644-1; manufactured per IPA provisions, as well as the directives for quality assurance GMP (Good Manufacturing Practice); Housing colour traffic white RAL 9016; Light distribution direct distribution by means of Multilayer lighting technology of PMMA, Using CDP micro prism pane and forward-scattering diffuser foil as multilayer technology, with clear cover made of laminated safety glass. Suitable for VDU workstations,  $65^\circ < 3000 \text{ cd/m}^2$  omnidirectional glare reduction in accordance with current DIN-EN 12464-1 standard, UGR (4H/8H) 17.9. Integrated LED driver design.. Electrical connection and connection of control cable using 5-pole connection terminal with plug-in contacts; Luminous flux in emergency light mode 5799 lm. The aduna clean room luminaire is suitable for direct voltage (0/50Hz), emergency luminaires must have additional marking. Suitable for air purity class ISO 14644-1 Class 2 with excellent to very good results in terms of microbial metabolic potential and chemical resistance.

## CHARACTERISTICS

|                               |  |
|-------------------------------|--|
| Order number                  | 62164016670  |
| EAN number                    | 4020863384525  |
| Commodity code                | 94051190   |
| Certification mark            | IP 65, Protection class I, $\gamma 65^\circ < 3000 \text{ cd/m}^2$ ,<br>F, D, Clean room, HACCP<br>DIN10500/Food/IFS/BRC, Indoor, CE |
| Impact resistance (IK rating) | IK07 (-20°C bis 35°C)  |
| Ambient temperatur            | ta -20°C to 35°C   |
| Special properties            | Ready for IoT  |
| Warranty period               | 7 years  |
| State funding programs        | BEG - Federal funding for efficient buildings<br>(valid only for Germany)  |

## ELECTRICAL ENGINEERING

|                                      |   |
|--------------------------------------|---|
| Controller                           | Electronic driver DALI2 (1 pcs.)                              |
| System output                        | 48W   |
| Mains voltage                        | 230V/50Hz   |
| Circuit breakers (inrush current)    | 15 pieces/B10, 24 pieces/B16, 24<br>pieces/C10, 40 pieces/C16 |
| Energy efficiency class/light source | C   |

## LIGHTING TECHNOLOGY

|   |  |
|---|--|
| Placement                                     | LED, Colour<br>rendering/Light colour<br>CRI $\geq 90$ / 4000K |
| Colour tolerance (MacAdam)                    | 3SDCM  |
| Photobiological safety (Luminaire)            | RG0  |
| Nominal luminous flux                         | 5799lm   |
| Nominal luminous flux-emergency lighting mode | 5799lm   |
| LED service life                              | 100000h L80/B10 (Tq<br>35°C), 50000h L90/B10<br>(Tq 25°C)      |
| Luminaire luminous efficiency                 | 120lm/W  |
| UGR lat./long.                                | 17.9 / 17.8  |

## DEEP-LINK

<https://www.regiolux.de/en/article/62164016670>

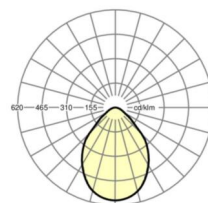

|                              |                                  |
|------------------------------|----------------------------------|
| Reference                    | LED 5800lm 940                   |
| $\eta_{LB}$                  | 100 %                            |
| $\Phi_{\downarrow/\uparrow}$ | 100 % / 0 %                      |
| UGR lat./long.               | 17.9 / 17.8                      |
| VDU                          | $65^\circ < 3000 \text{ cd/m}^2$ |

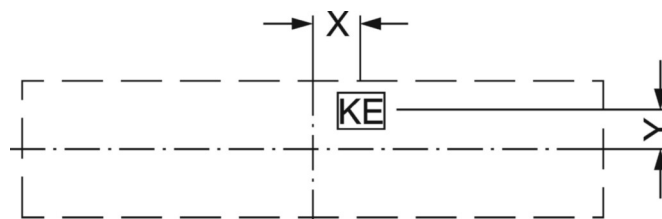
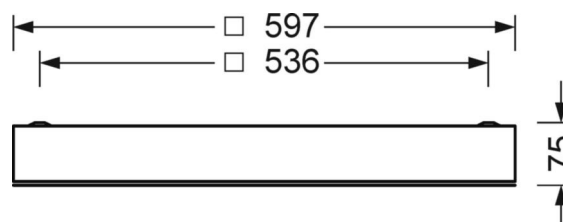

**MECHANICS**

|                               |  |
|-------------------------------|--|
| <b>Housing colour</b>         | traffic white RAL 9016   |
| <b>Dimensions (LxWxH/DxH)</b> | 597mm x 597mm x 75mm   |
| <b>Ceiling system</b>         | cut-out ceilings [AD]  |
| <b>Weight (net)</b>           | 10.9kg   |
| <b>Cable entry KE (X/Y)</b>   | 279mm/17mm   |
| <b>Type of installation</b>   | Ceiling-mounted single installation,<br>Ceiling-mounted trunking installation,<br>Installation in clean room ceilings, Ceiling<br>installation individual mounting |

**Dimensions**

|           |        |   |
|-----------|--------|---|
| <b>L</b>  | 597 mm | Length  |
| <b>B</b>  | 597 mm | Width   |
| <b>H</b>  | 75 mm  | Height  |
| <b>A1</b> | 536 mm | Mounting distance single mounting                                     |
| <b>X</b>  | 279 mm | Distance cable infeed to the center of the luminaire<br>on the X-axis |
| <b>Y</b>  | 17 mm  | Distance cable infeed to the center of the luminaire<br>on the Y-axis |